

PHASE 3

Modélisation

Agencement & plans techniques

Aménager l'hôpital pour accueillir les familles

*Une démarche d'innovation centrée-usagers
pour conception collaborative de
solutions d'accueil des familles*

Avec le soutien de

SOMMAIRE



Fondation
Roche

étrangeOrdinaire



1 / CRÉATION DE L'AMÉNAGEMENT FINAL SUITE AUX RETOURS DU COMITÉ DE PILOTAGE p.05

- Réinterprétation
- Aménagement général
- Flux passage
- Zones d'interaction
- Mesures générales
- Rendu brut (sans teintes)

2 / MODULES ET PLANSTECNIQUES p.13

- Espace d'évasion : Paravent biblio & banquette d'angle
- Espace d'isolement : Fauteuil de lecture
- Espace de partage : Banquette restauration
- Espace cuisine : Bar & kitchenette

3 / COULEUR ET MISE EN SITUATION p.22

- Proposition colorée
- Rendus 3D finaux

4 / PLAFONNIERS p.26

5 / SIGNALÉTIQUE COULOIR..... p.30

1

CRÉATION DE L'AMÉNAGEMENT FINAL SUITE AUX RETOURS DU COMITÉ DE PILOTAGE

Réinterprétation

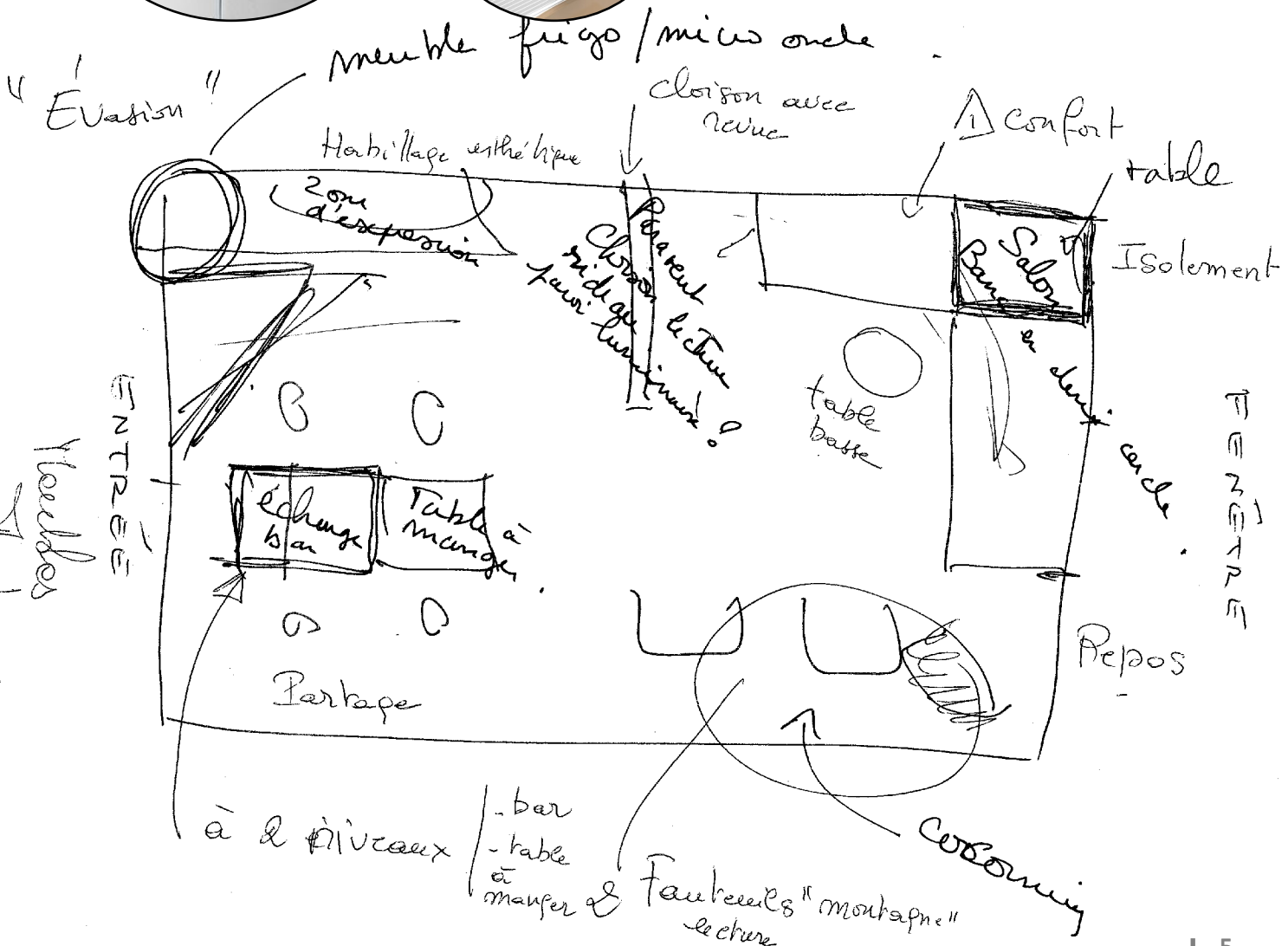
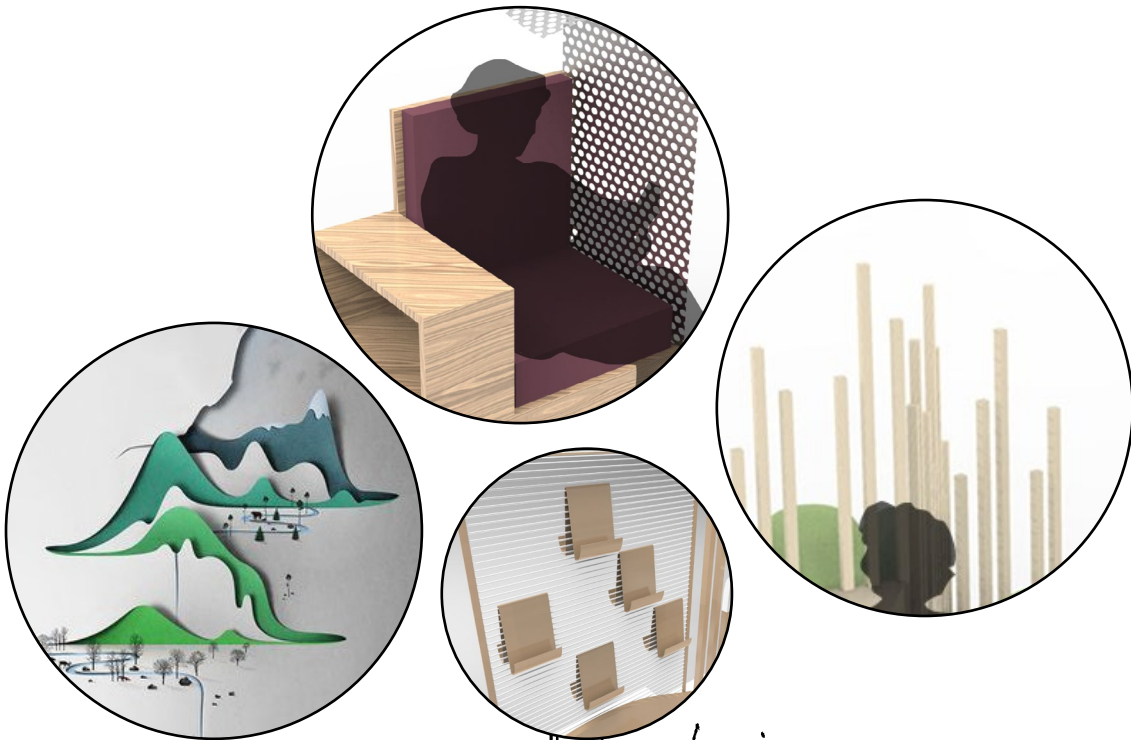

Aménagement général

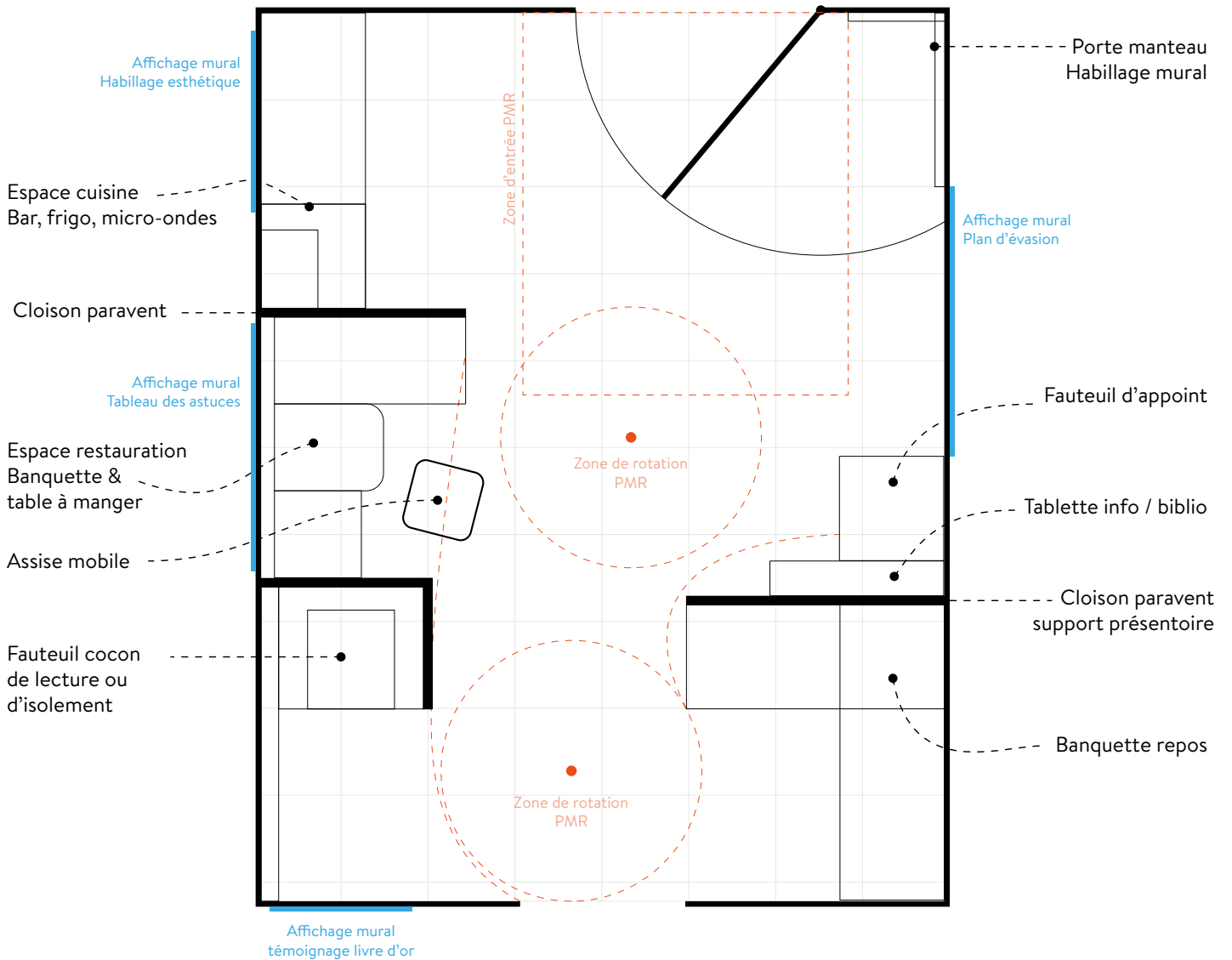

Flux passage

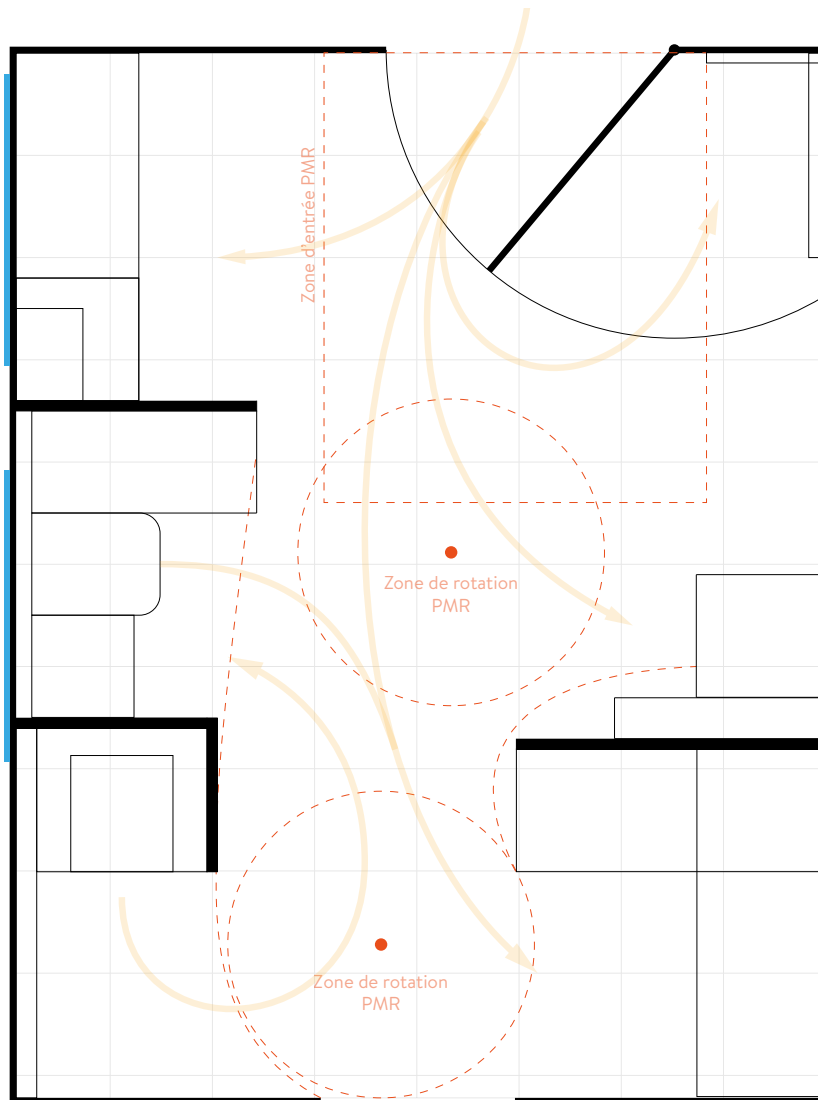

Zones d'interaction

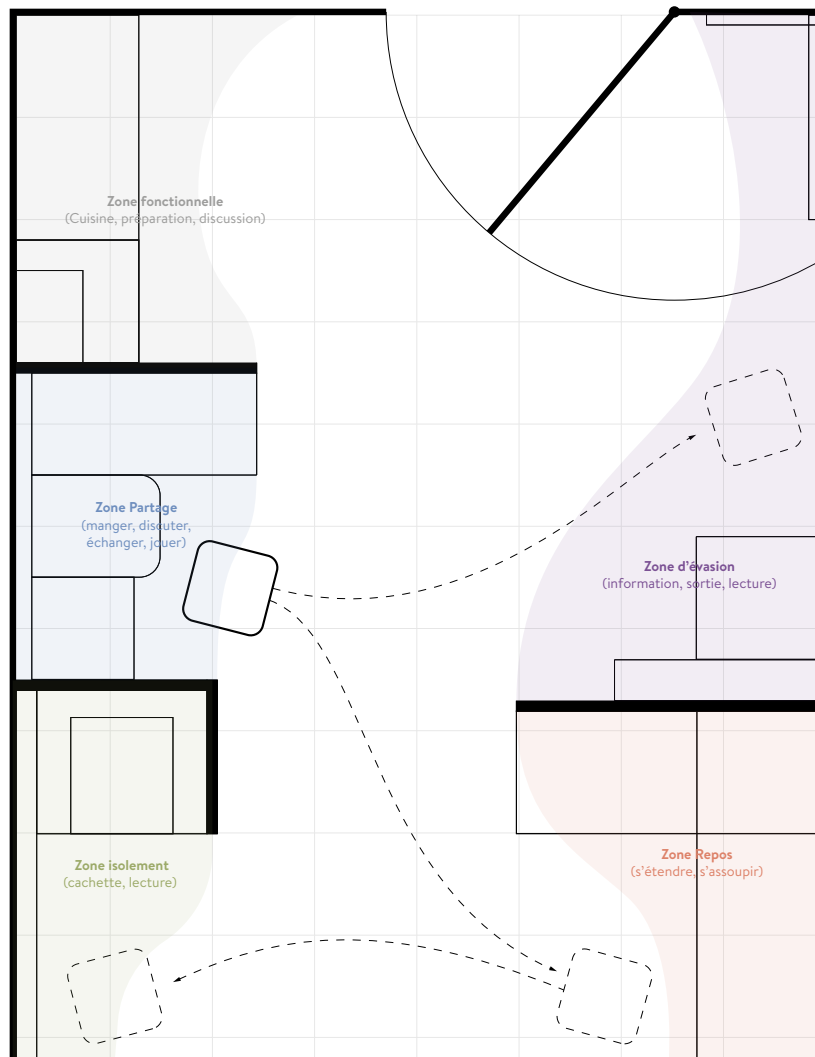

Mesures générales

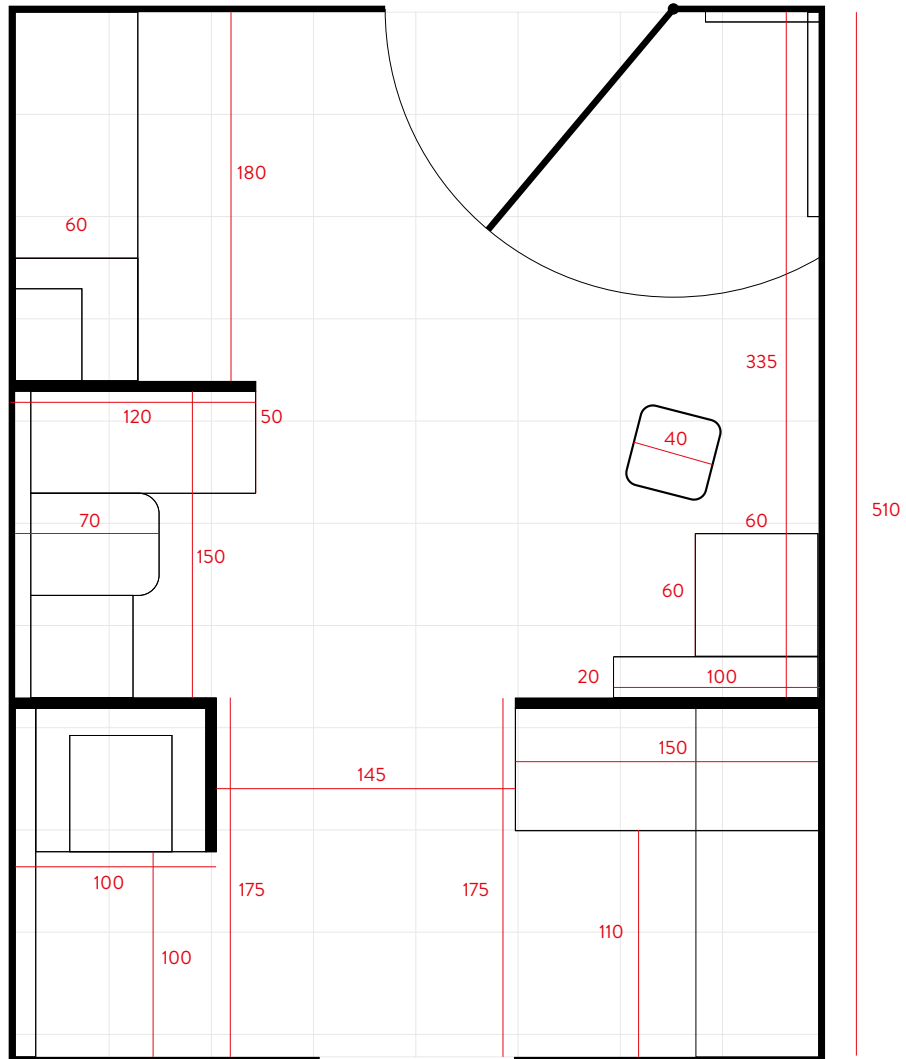

Rendu brut (sans teintes)

Vue sud

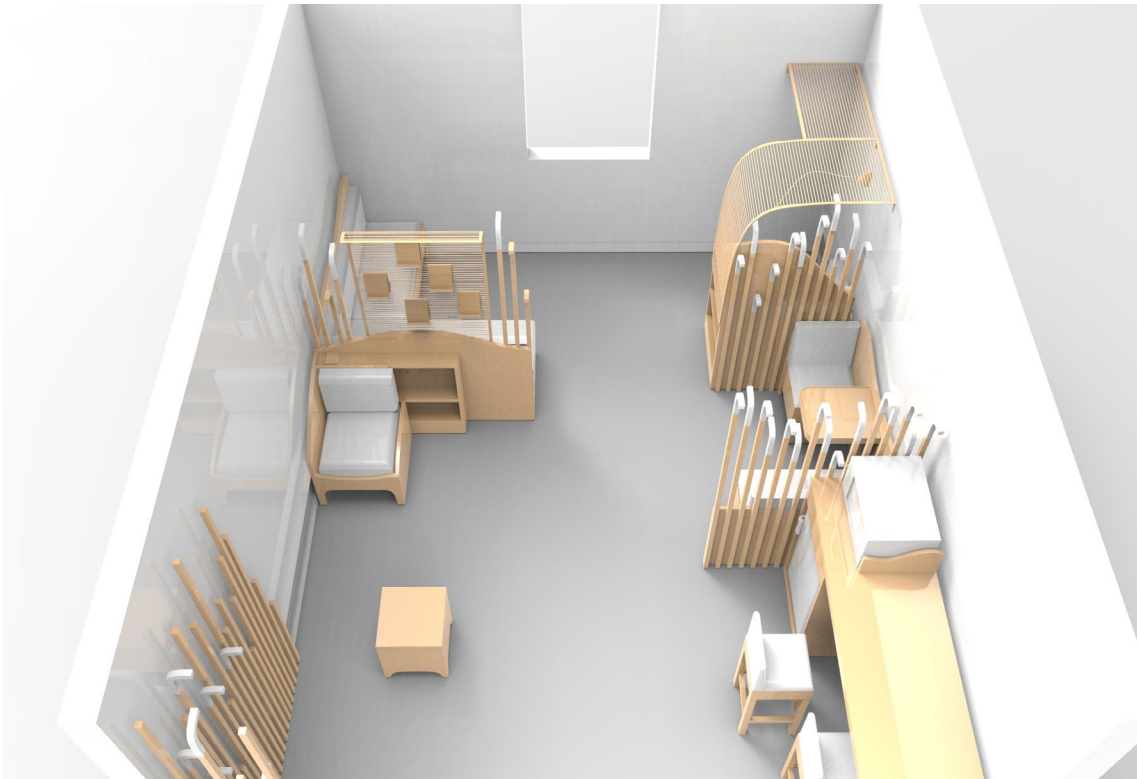

Vue ouest

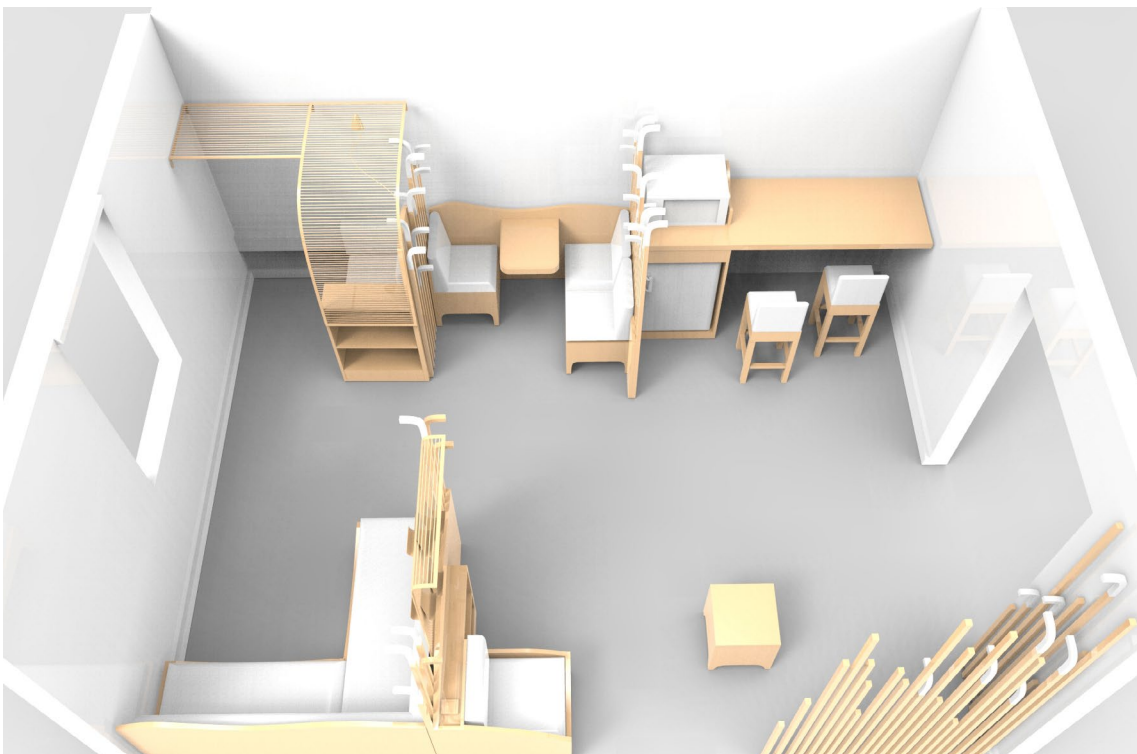

Rendu brut (sans teintes)

Vue nord

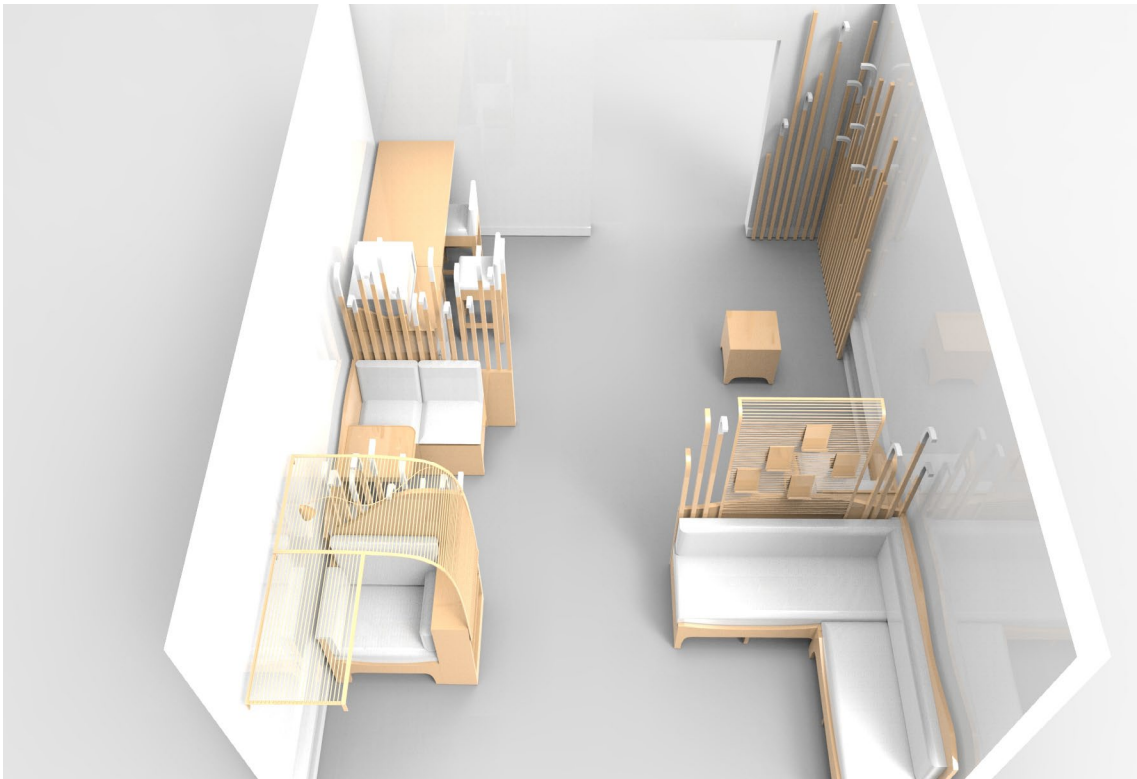

Vue est



Rendu brut (sans teintes)



2

MODULES ET PLANS TECHNIQUES

Module 1

Espace d'évasion

Paravent biblio & banquette d'angle

Rendu brut (sans teintes)

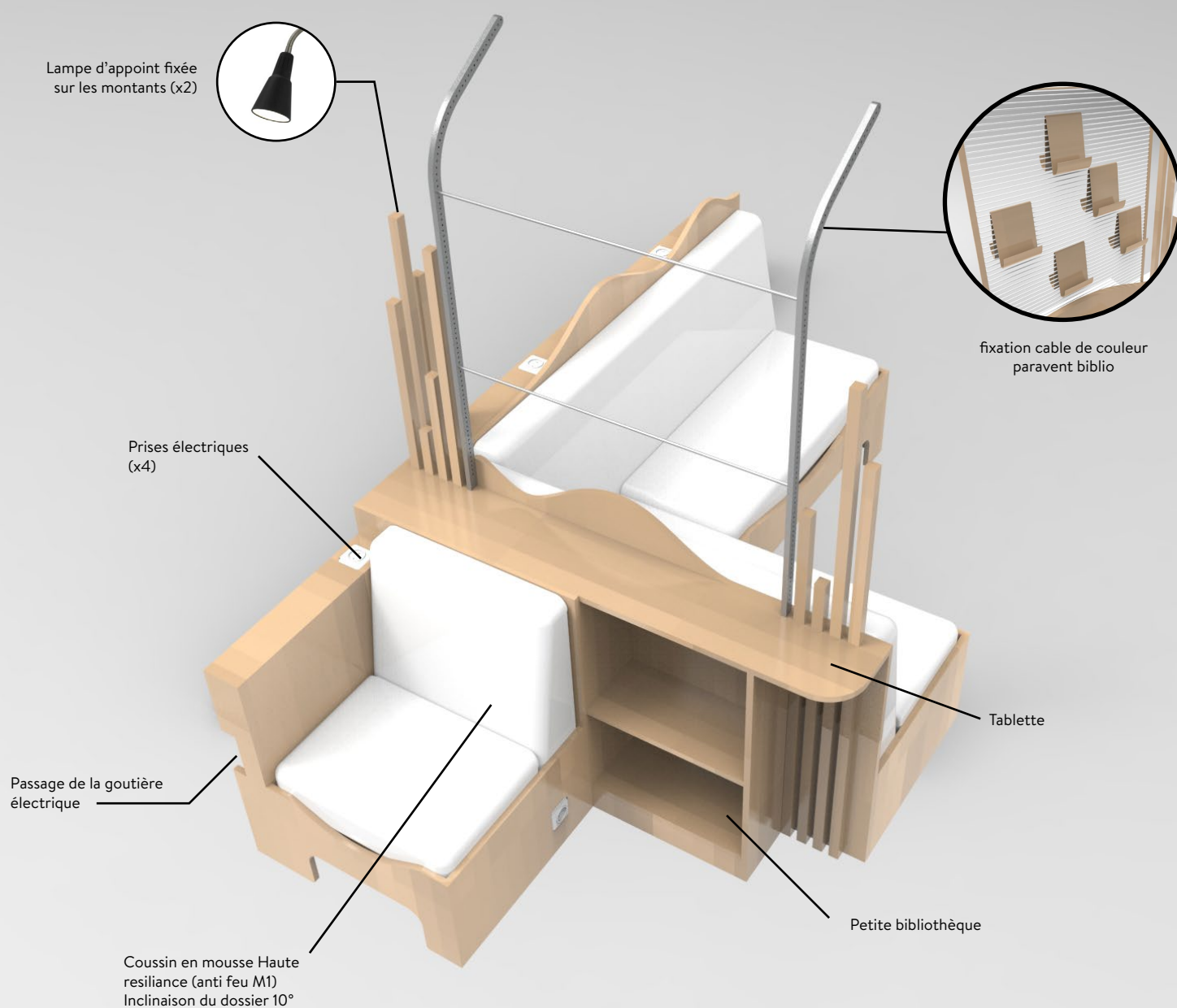

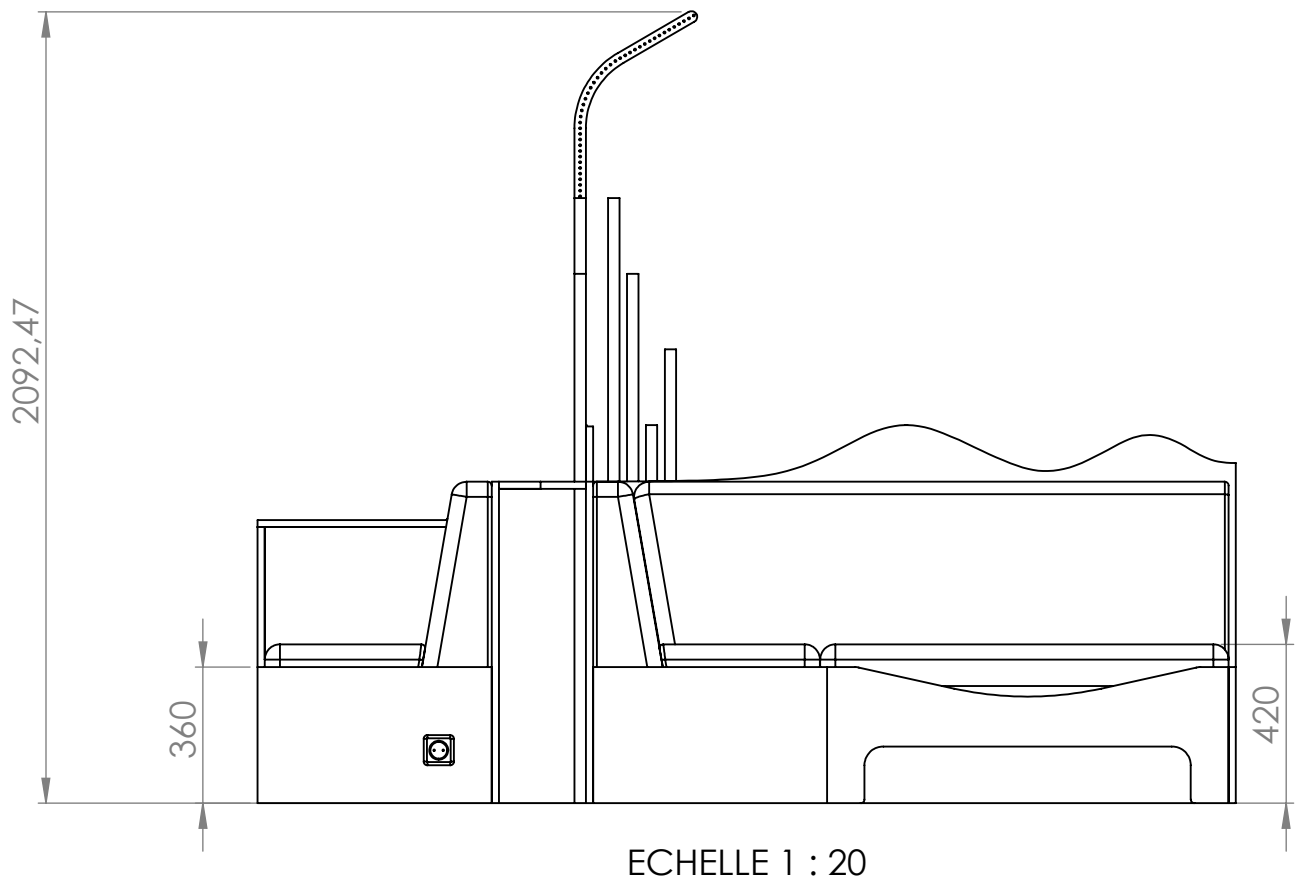
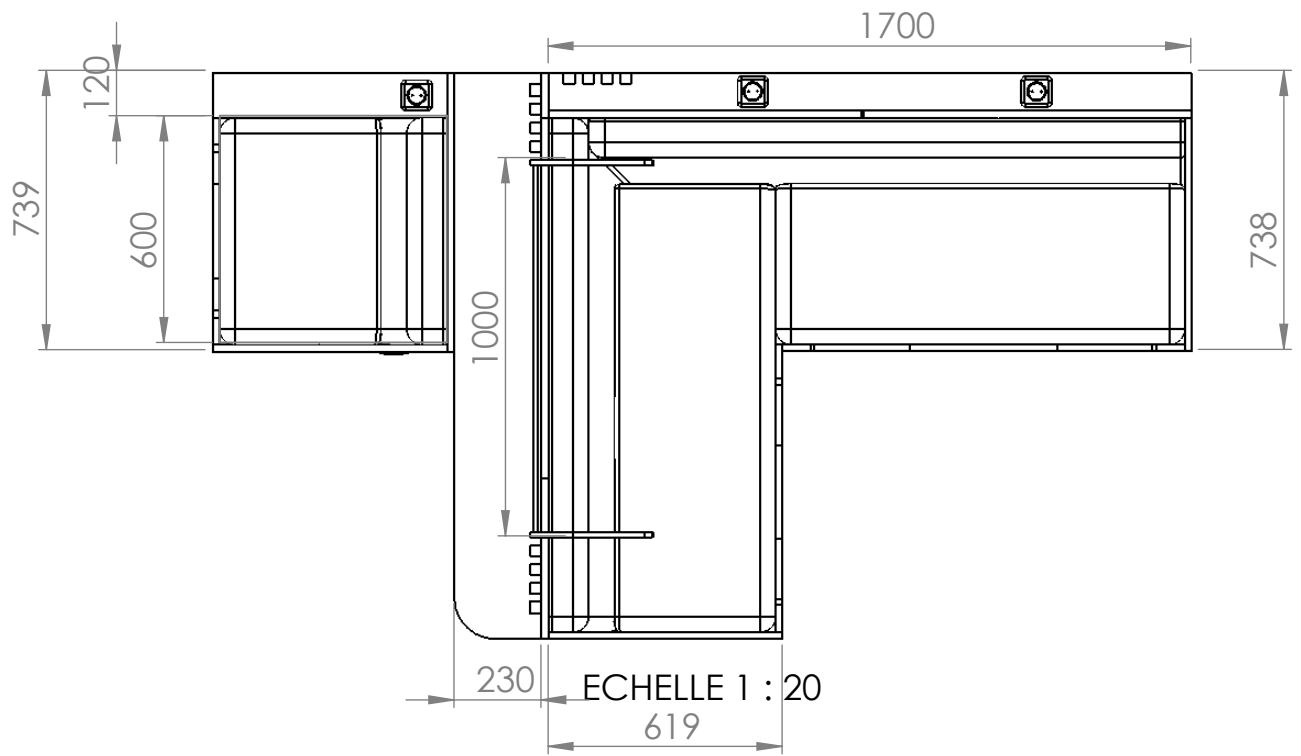

Module 2

Espace d'isolement

Fauteuil de lecture

Rendu brut (sans teintes)

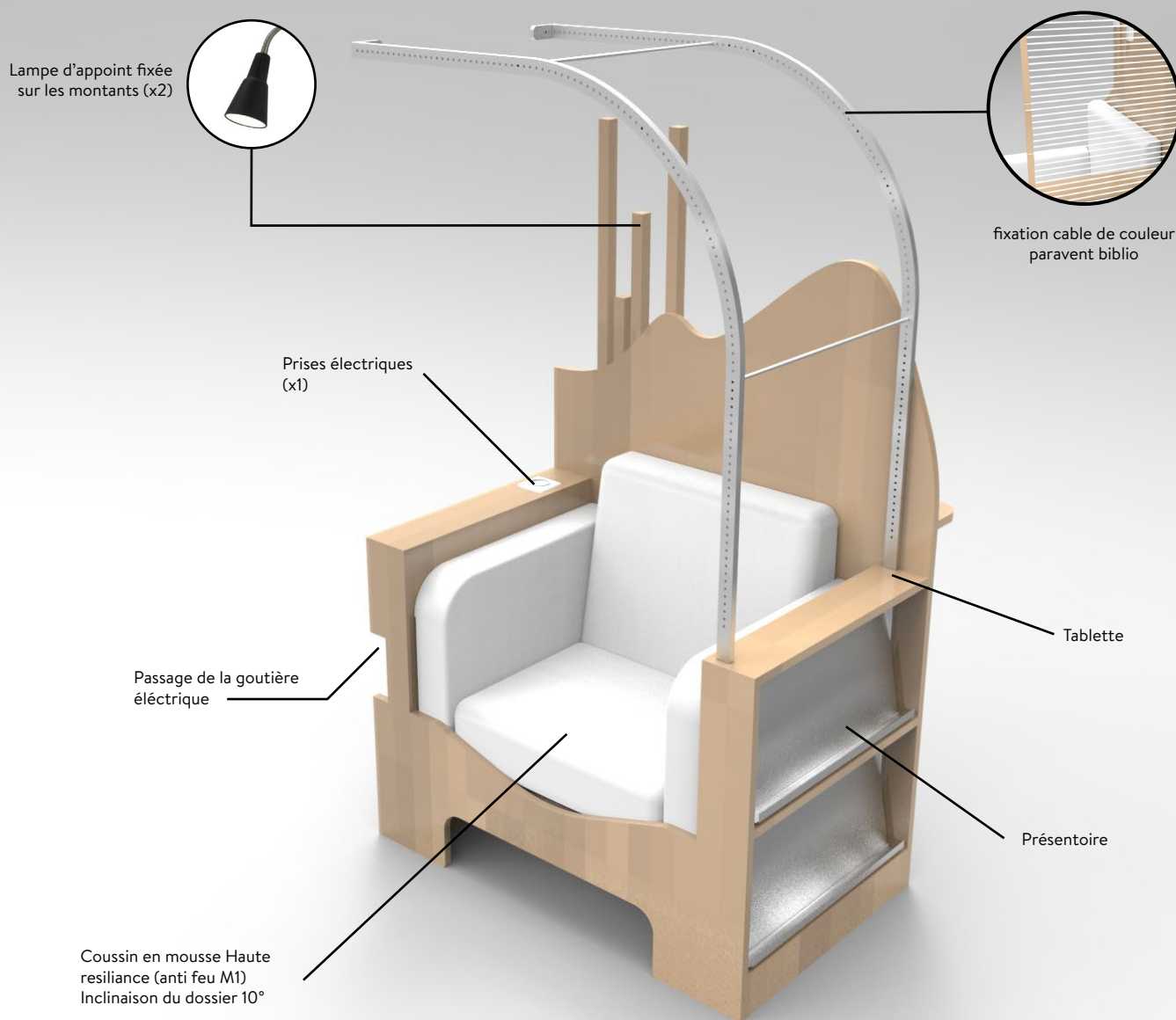

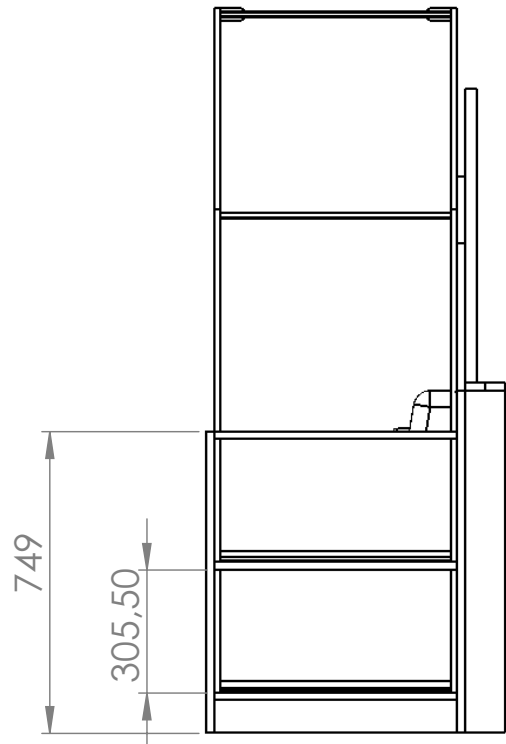
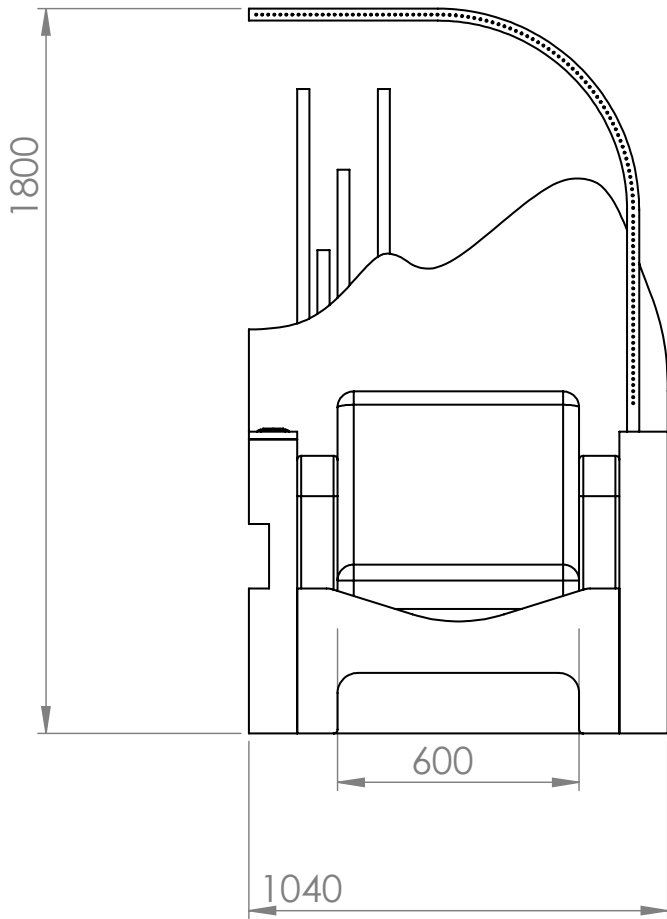
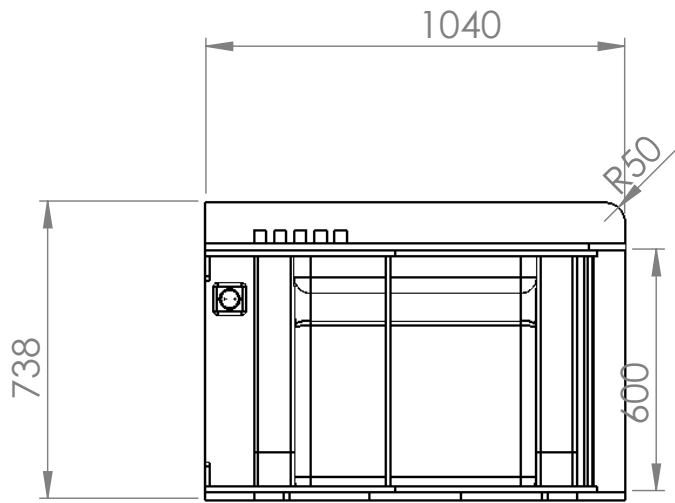

Module 3

Espace de partage

Banquette restauration

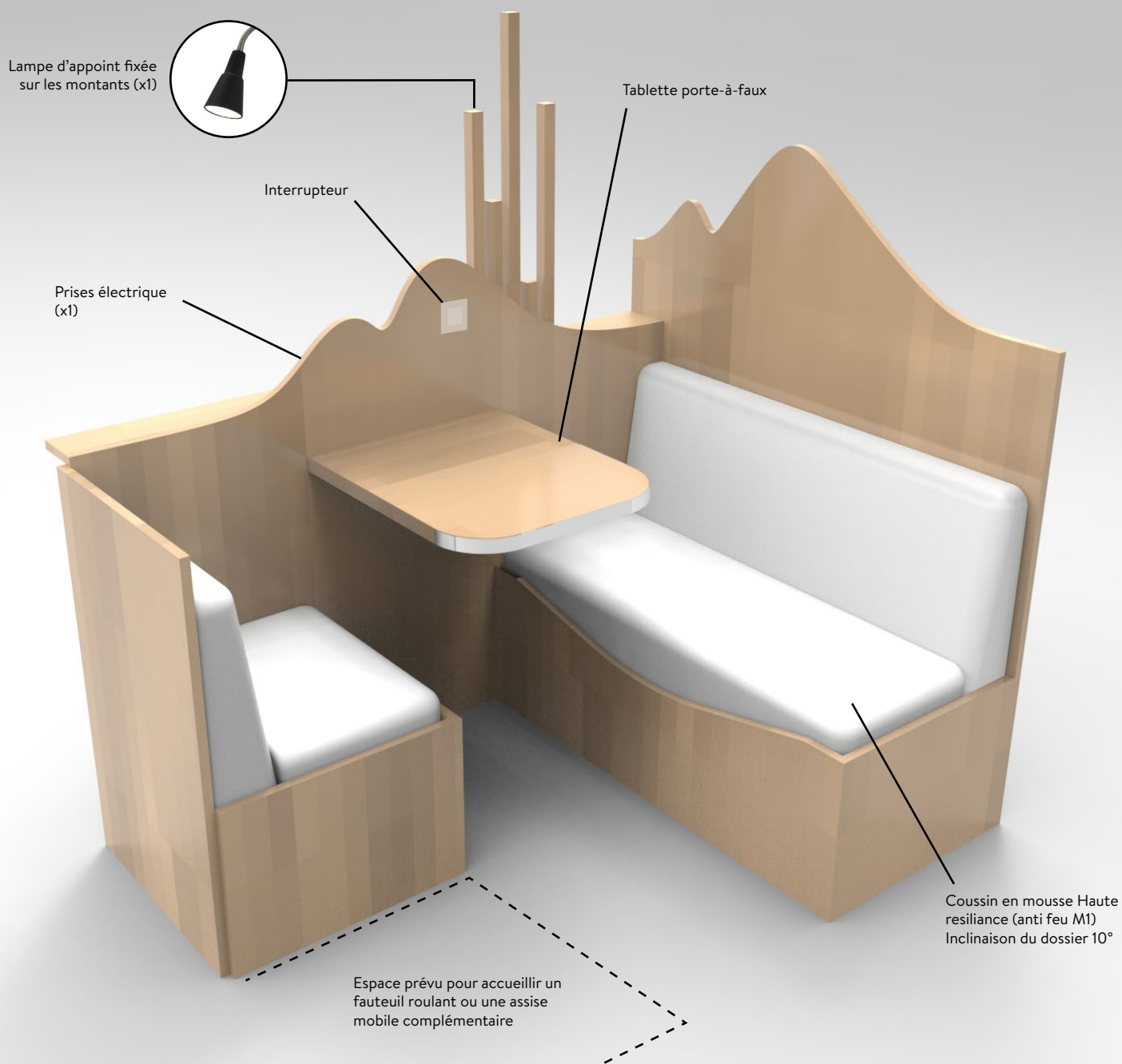

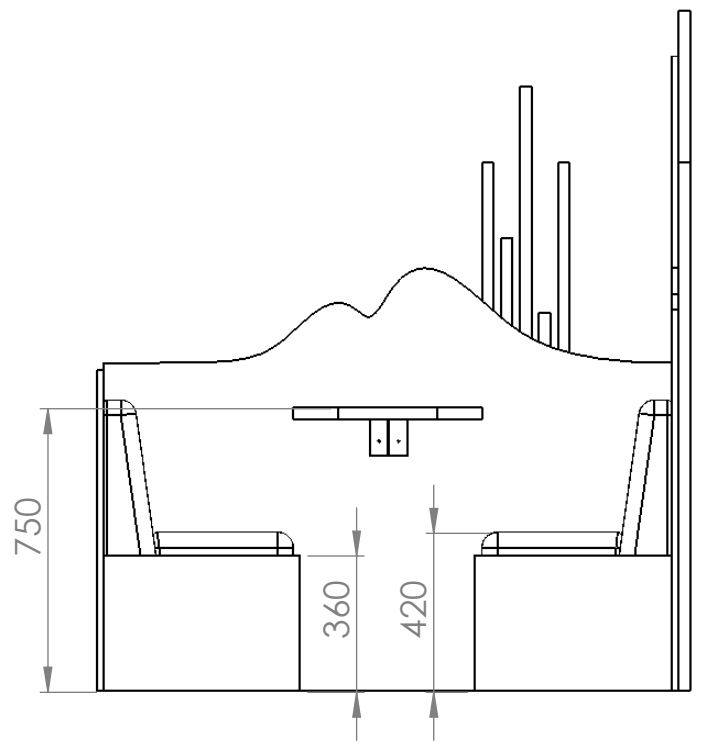
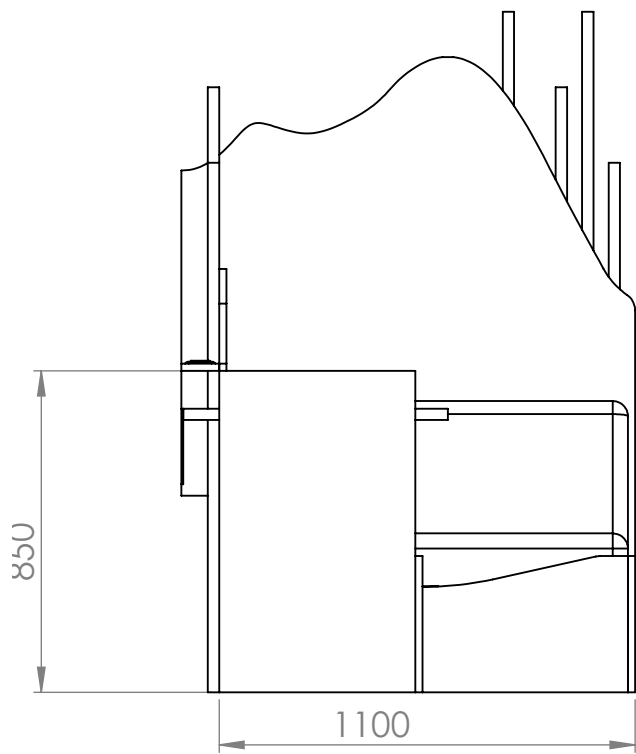
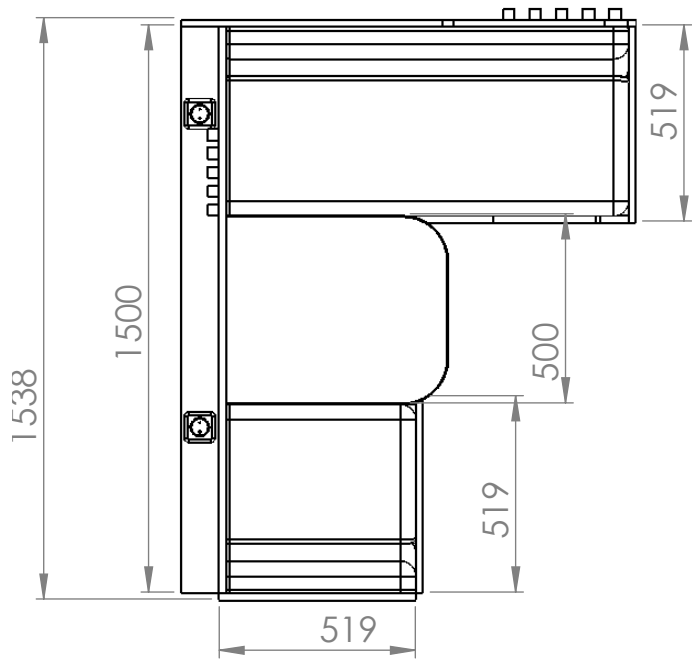

Module 4

Espace cuisine

Bar & kitchenette

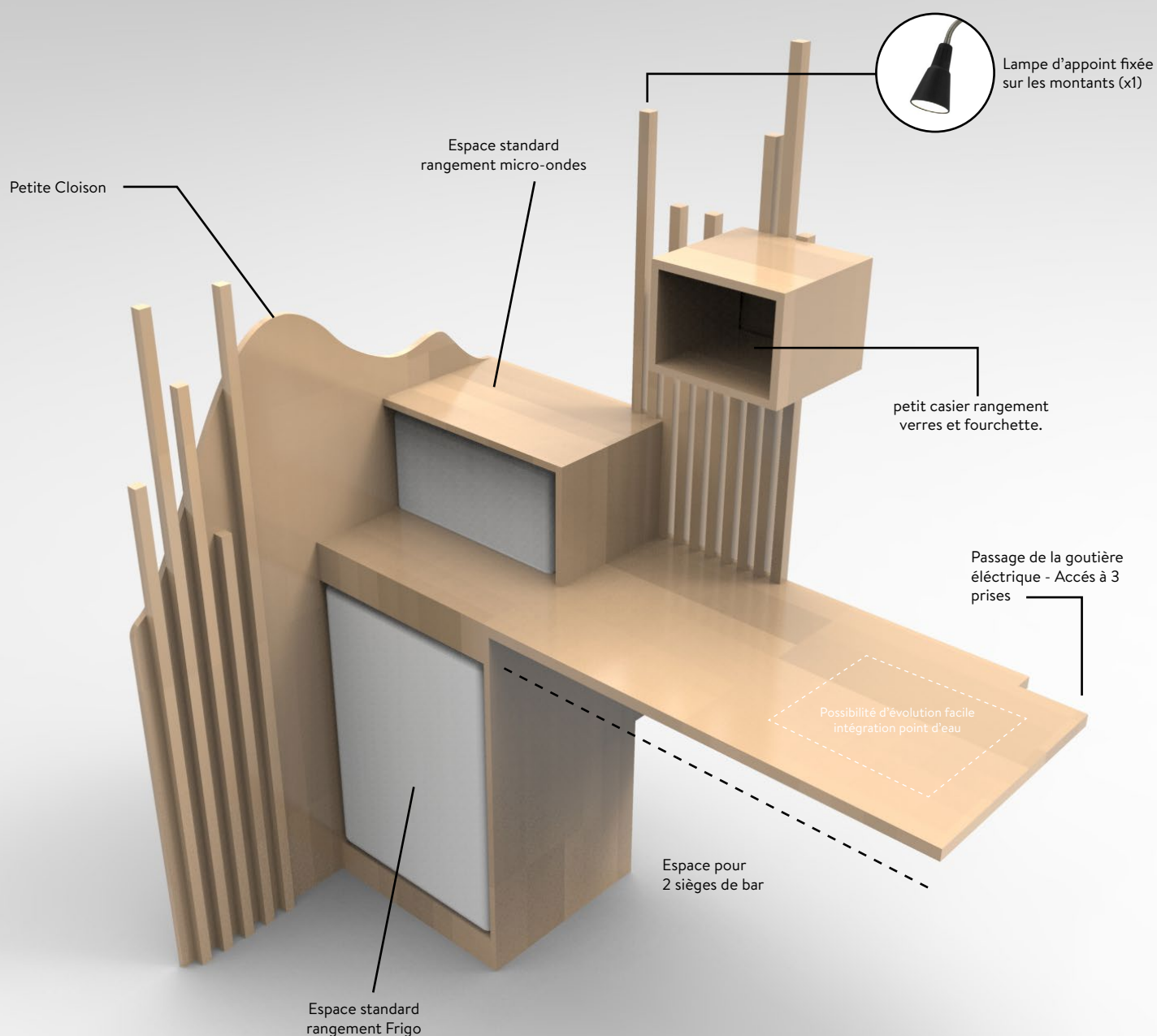

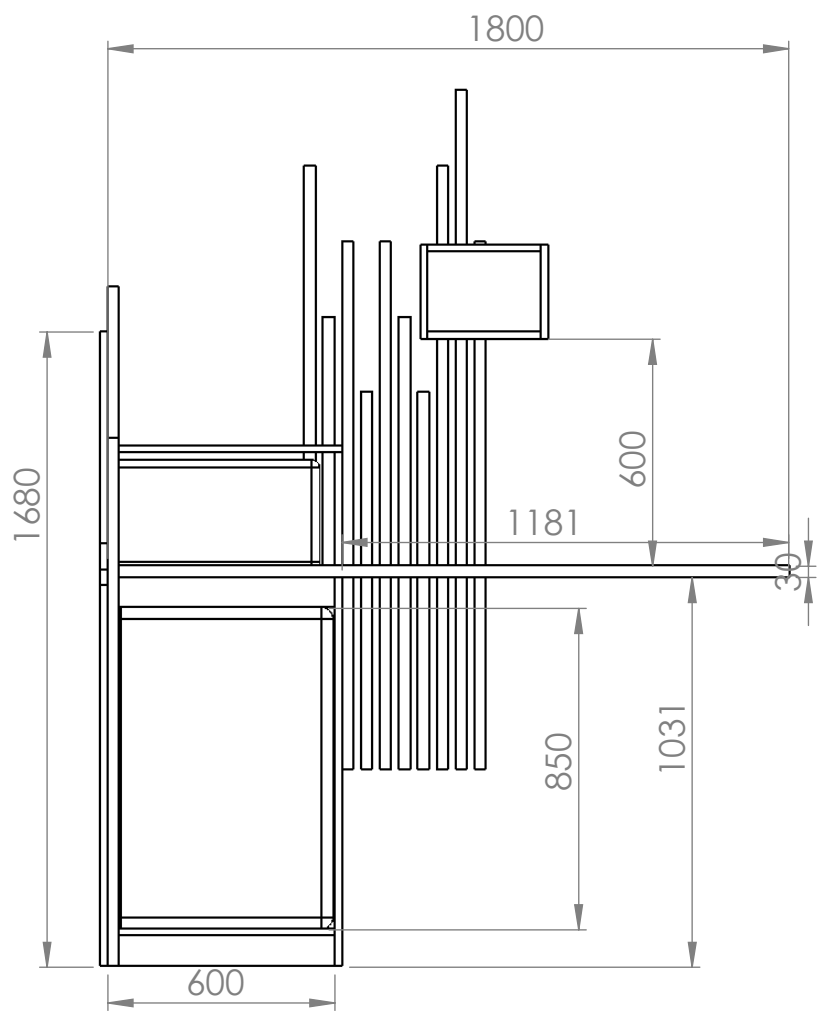
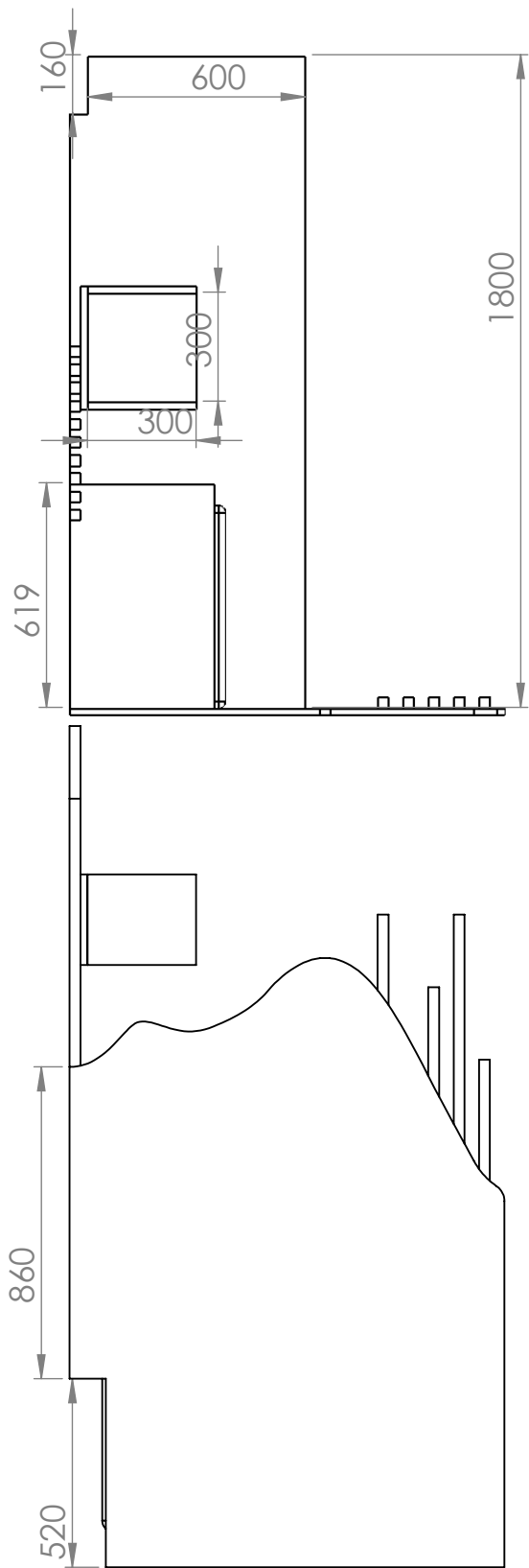

3

COULEUR ET MISE EN SITUATION





Mise en situation rapide

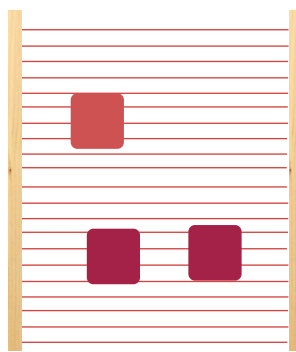
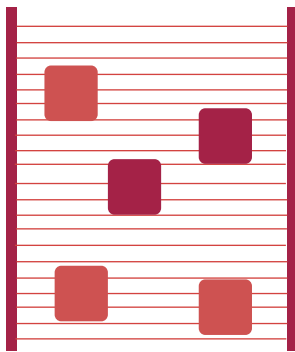
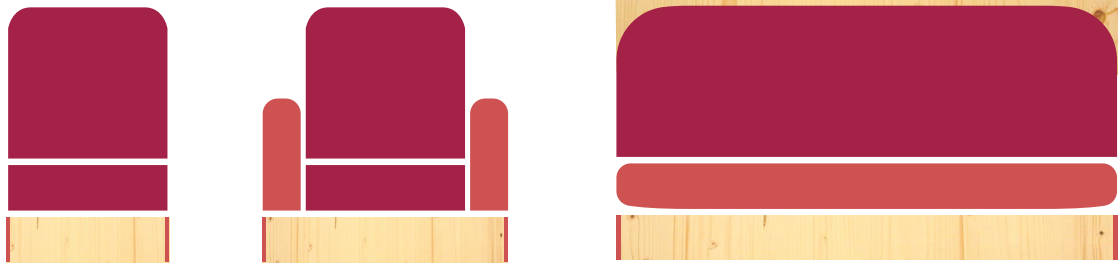

OPTION 3

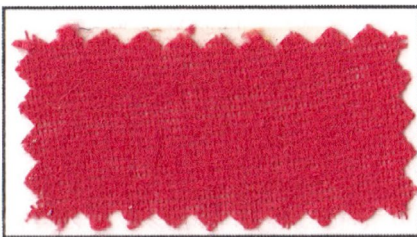

TIS18300

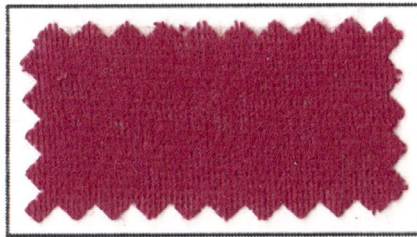

TIS18180



RENDUS 3D FINAUX

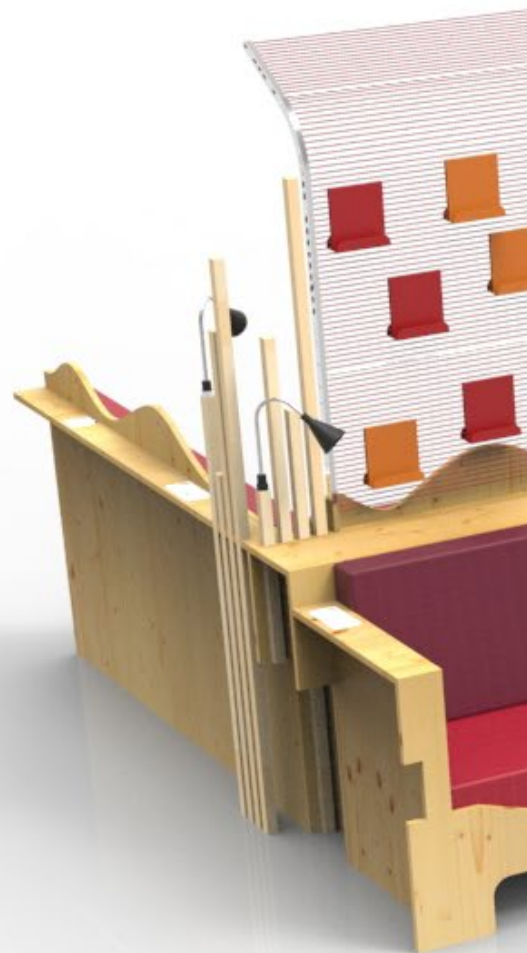
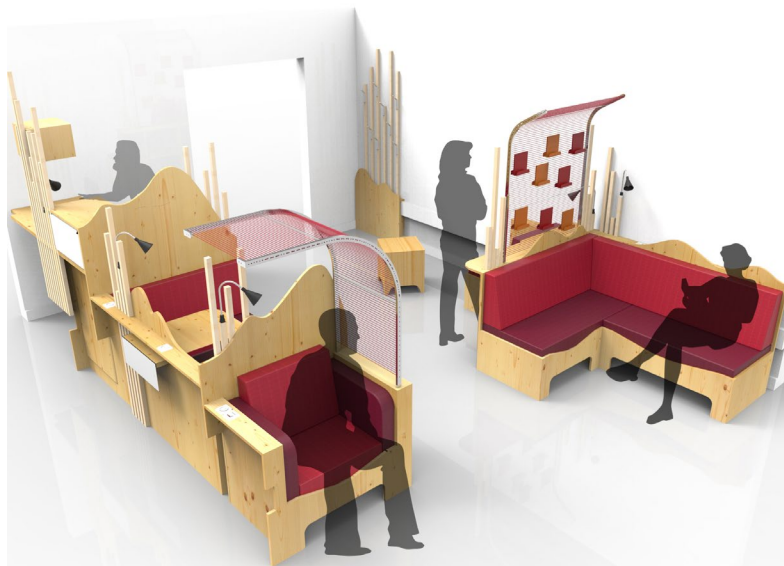

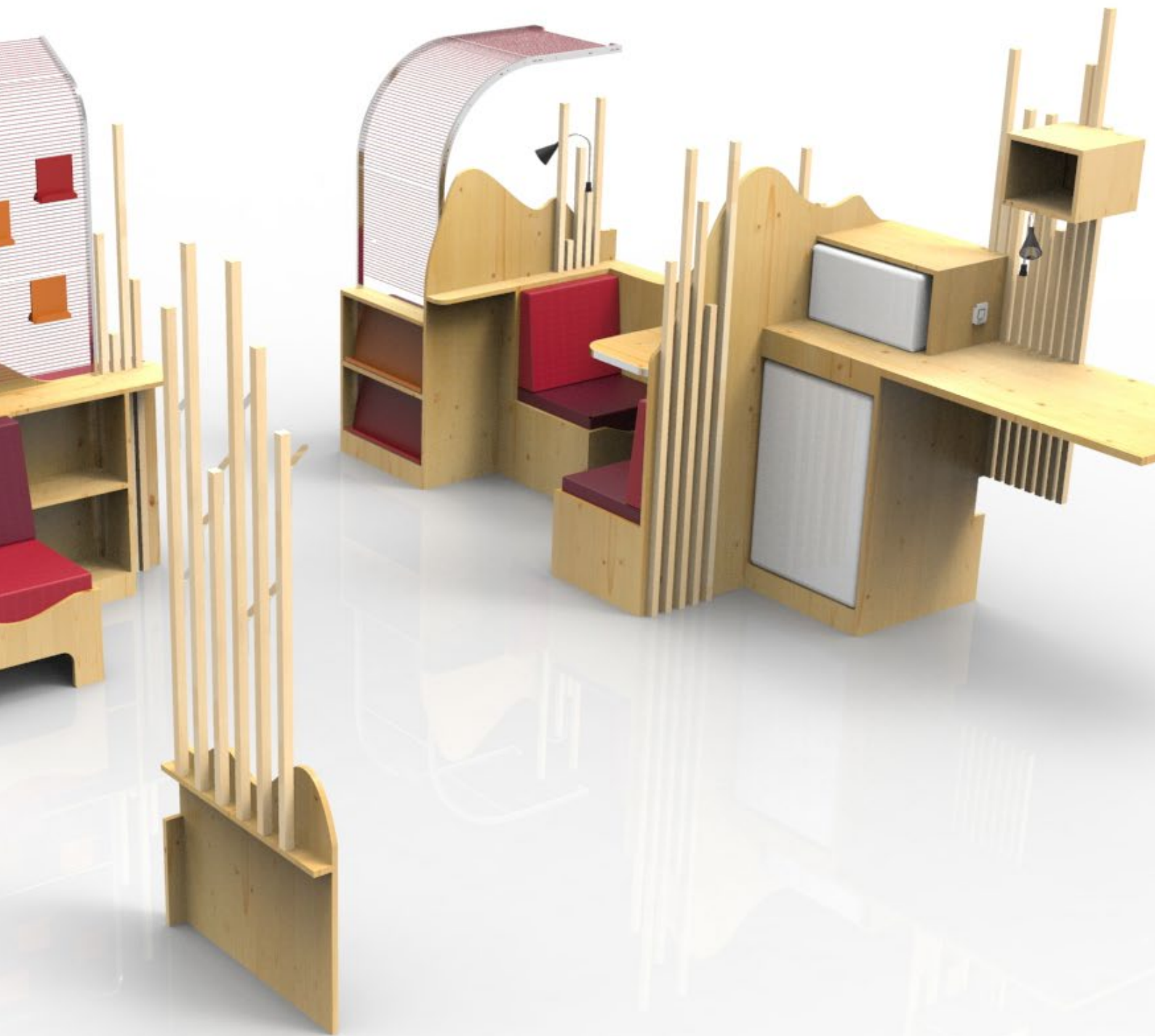

4

PLAFONNIERS

Plan plafond

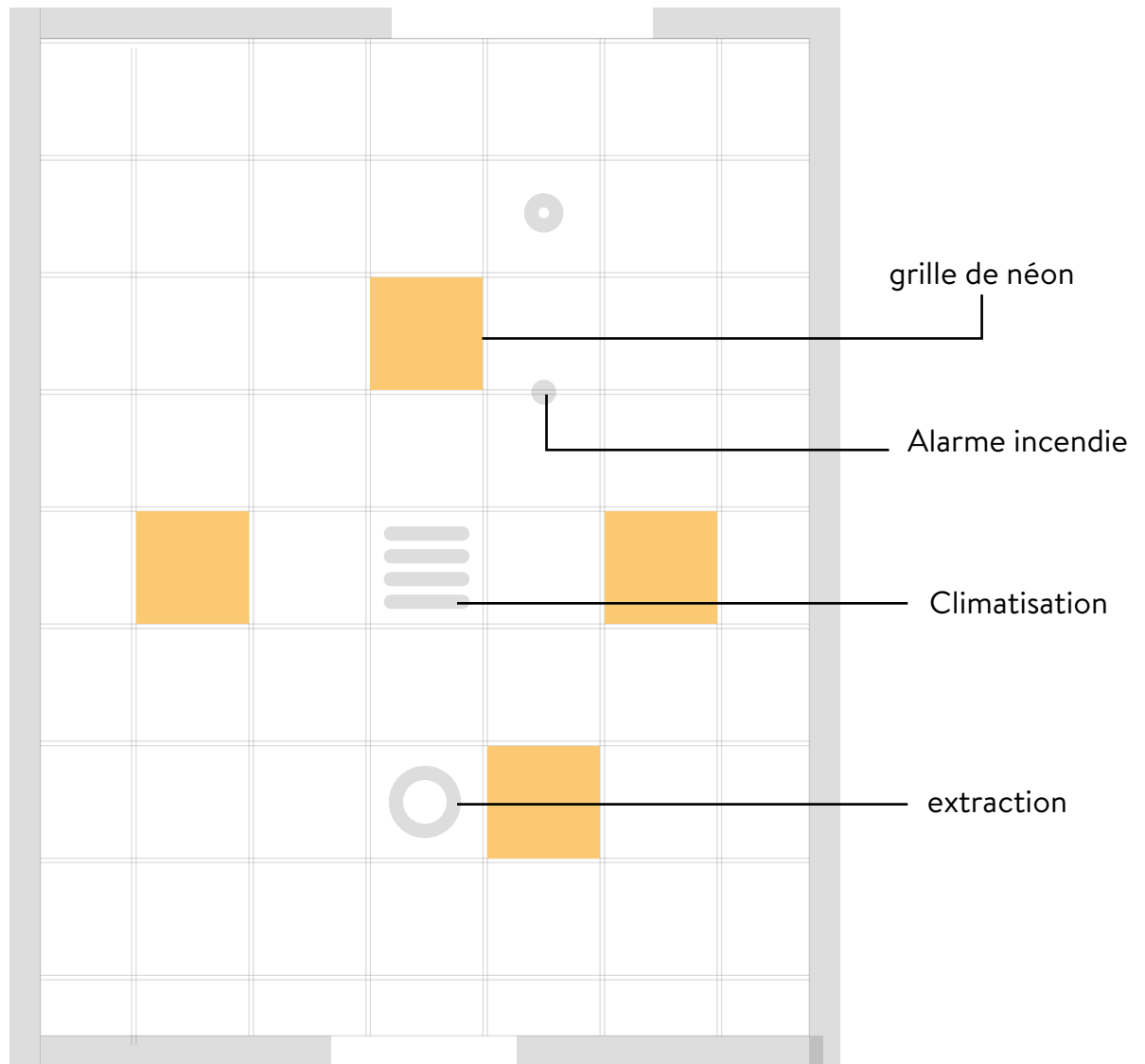

Plafonnier

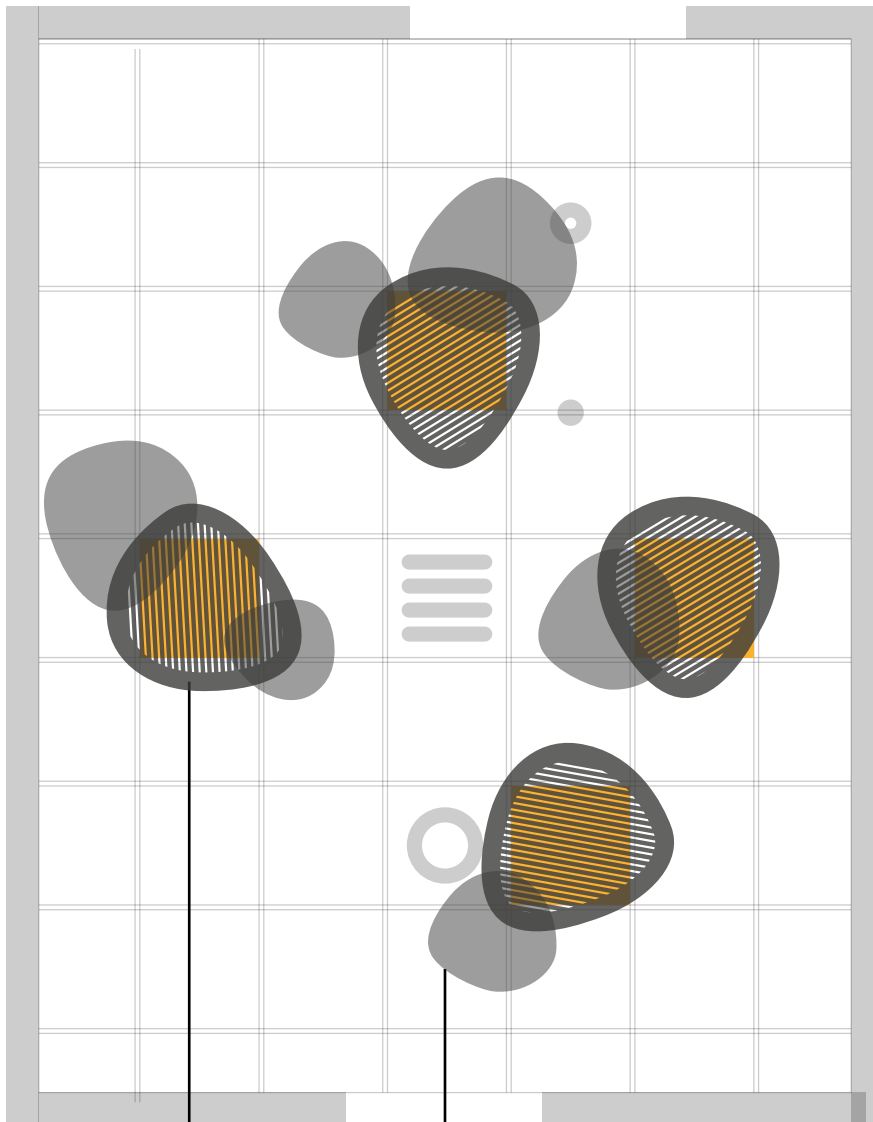

PVC acrylic
translucide 3mm



Couleur à déterminer
en fonction de la
colorimétrie
sélectionnée

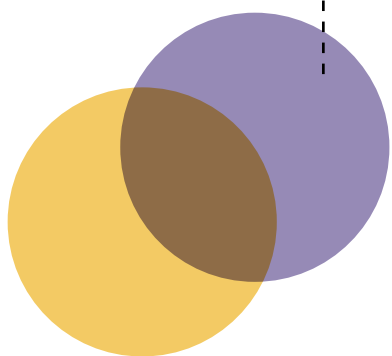
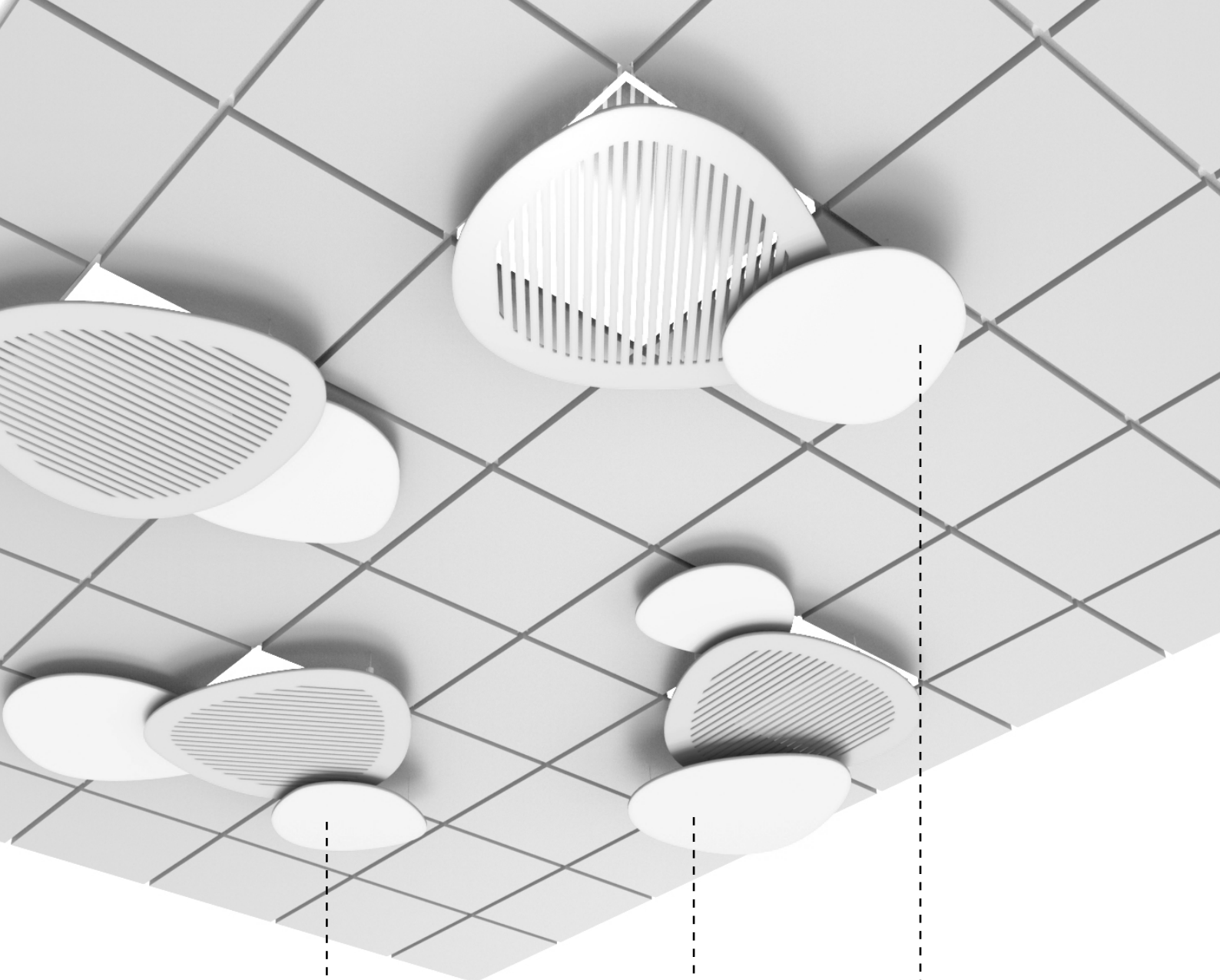

Teintes proposées

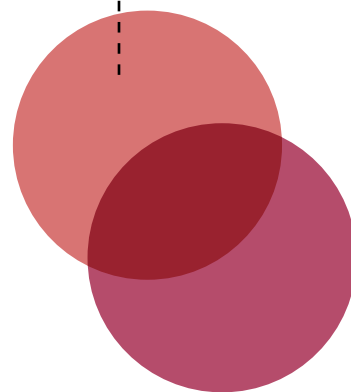
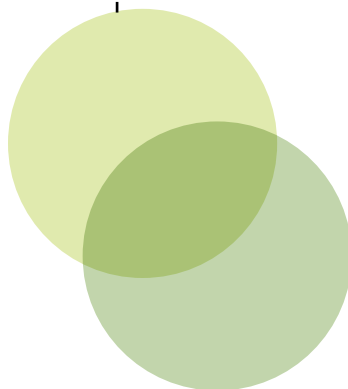

5 SIGNALÉTIQUE COULOIR

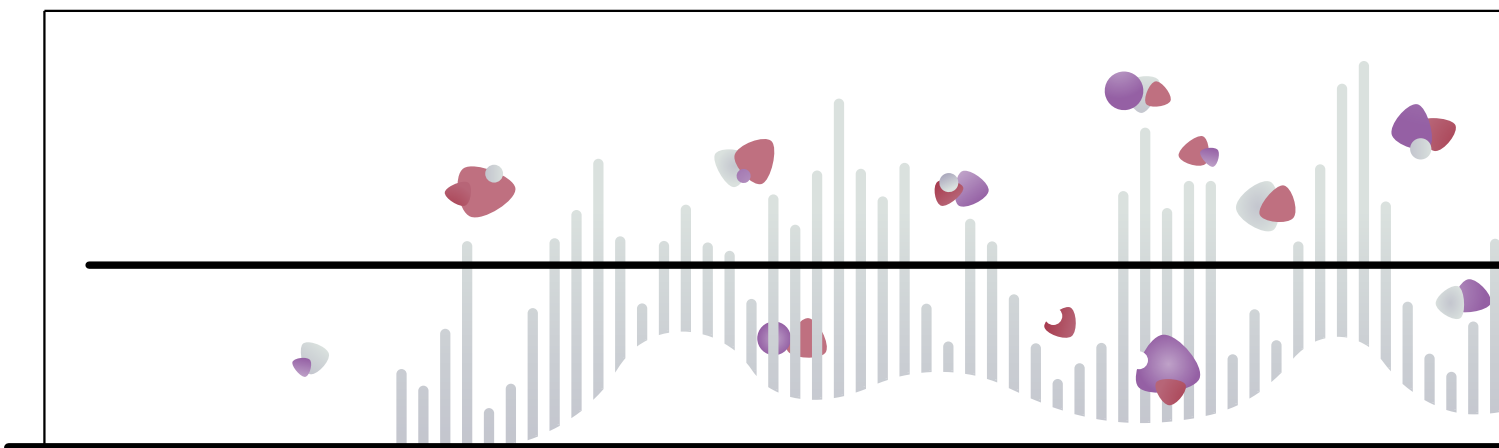
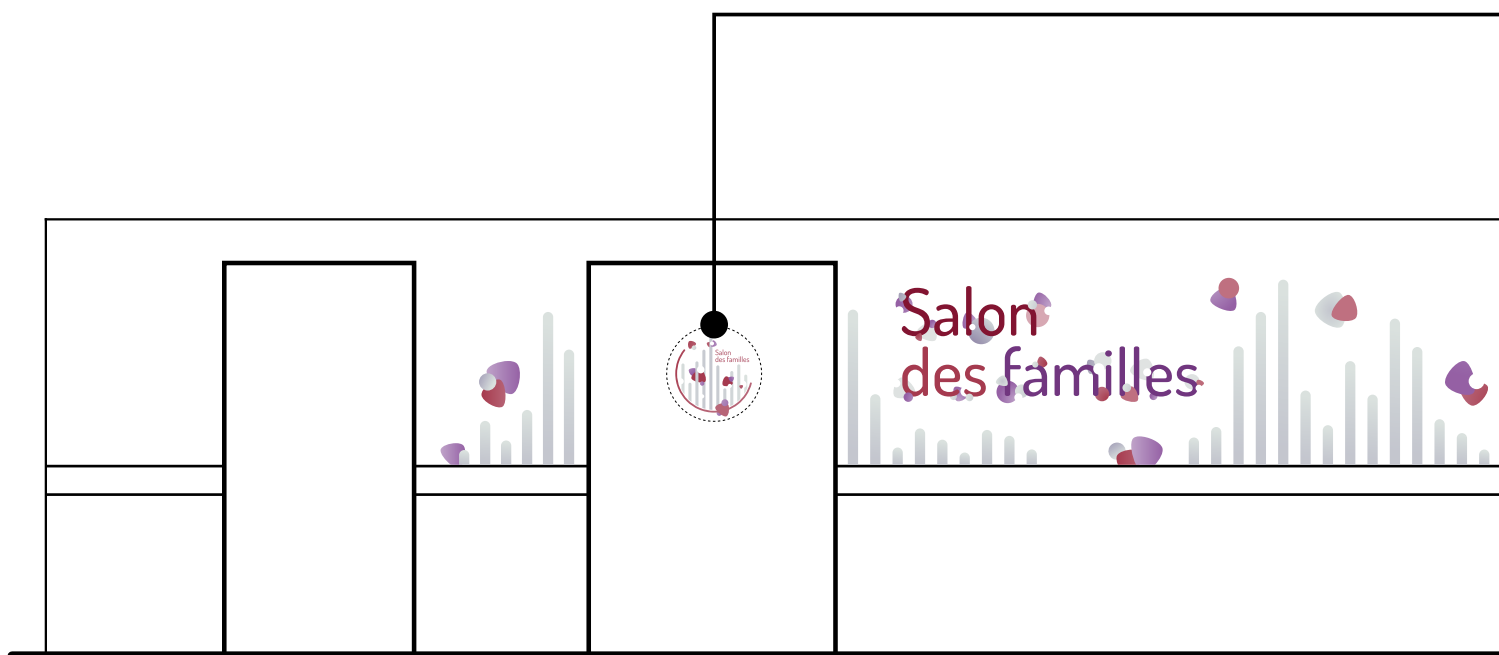

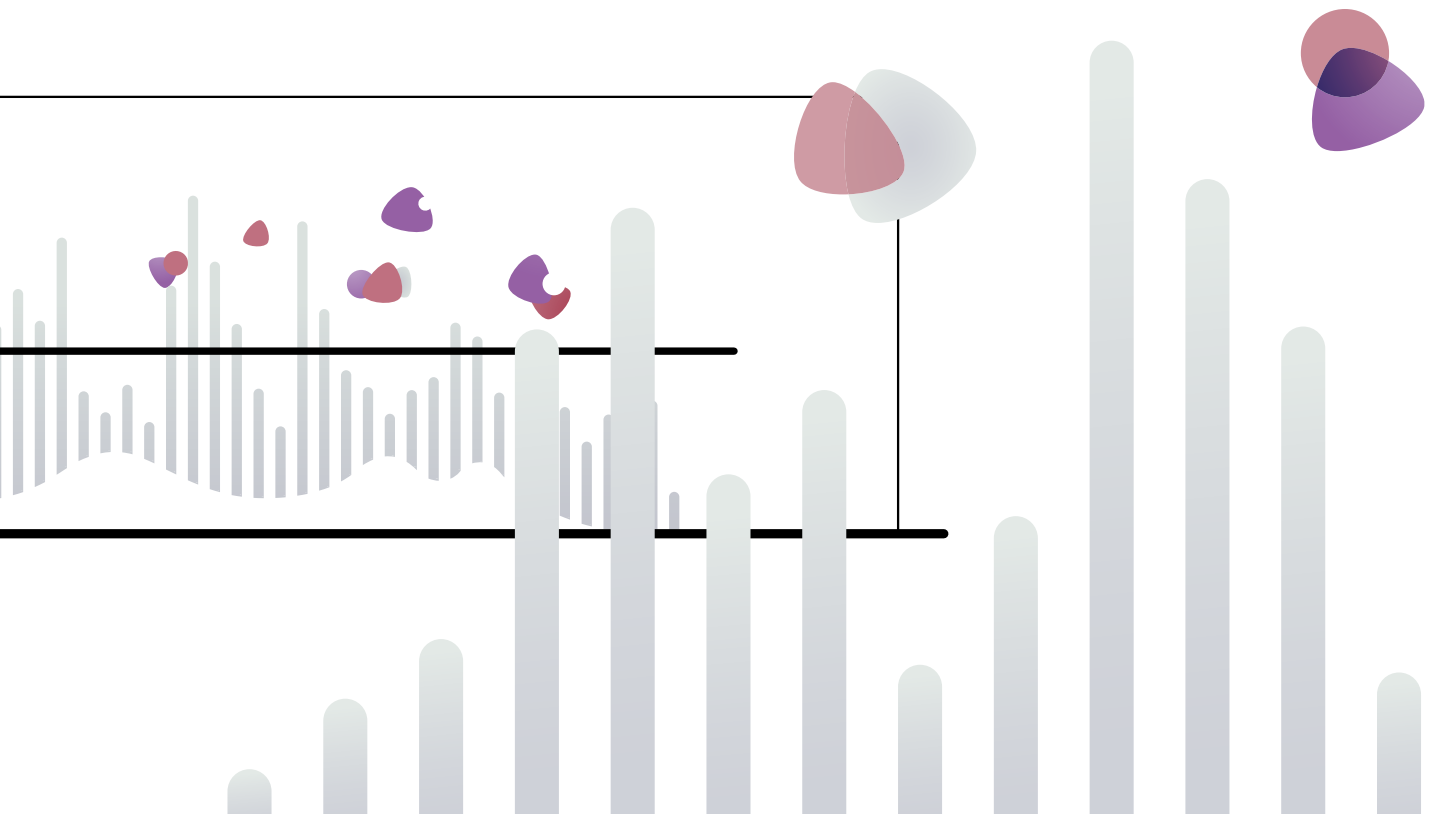
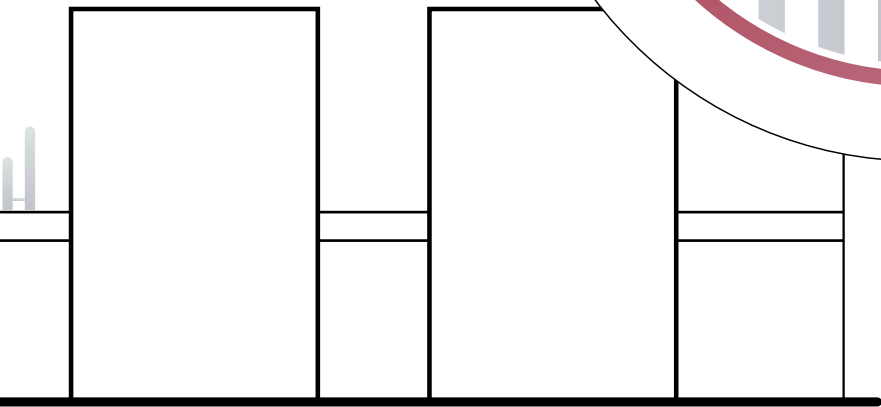



plus d'informations sur :
www.ap-hm/salondesfamilles

étrangeOrdinaire
Design de service & innovation sociale



**Assistance Publique
Hôpitaux de Marseille**